

- NOTES:**
- WHEN INSTALLING PROPOSED WASTEWATER SEWERS ON LEILA AVE TAKE CAUTION WHEN CROSSING EXISTING RESIDENTIAL WATER SERVICES.
  - CONTRACTOR SHALL VERIFY ELEVATION OF EXISTING SEWER SERVICES AT PROPOSED DOWNSTREAM CONNECTION LOCATIONS PRIOR TO INSTALLATION OF COLLECTOR WWS TO ALLOW FOR CHANGES OF GRADE TO THE COLLECTOR WWS.

SEWER SERVICE INFORMATION					
ADDRESS	STATUS	SIZE (mm)	COORDINATES AT JUNCTION	COORDINATES AT PROPERTY	REMARKS
#640 MATHIAS AVE	ACTIVE	250 UNKNOW	N=5534625.38 E=633870.65	UNKNOW	NONE
#632/634 LEILA AVE	ACTIVE	150 UNKNOW	N=5534627.12 E=633866.91	N=5534618.09 E=633861.05	NONE
#636/638 LEILA AVE	ACTIVE	150 UNKNOW	N=5534633.05 E=633854.23	N=5534623.95 E=633848.55	NONE
#640 MATHIAS AVE	ACTIVE	200 UNKNOW	N=5534635.58 E=633848.81	N=5534658.55 E=633860.74	NONE
#640/642 LEILA AVE	ACTIVE	150 UNKNOW	N=5534640.34 E=633838.65	N=5534631.65 E=633832.08	NONE
#644/646 LEILA AVE	ACTIVE	150 UNKNOW	N=5534646.65 E=633825.19	N=5534637.47 E=633819.66	NONE
#648/650 LEILA AVE	ACTIVE	150 UNKNOW	N=5534653.51 E=633810.48	N=5534644.39 E=633804.95	NONE
#652/654 LEILA AVE	ACTIVE	150 UNKNOW	N=5534660.30 E=633795.96	UNKNOW	NONE
#656/658 LEILA AVE	ACTIVE	150 UNKNOW	N=5534666.51 E=633782.67	N=5534657.58 E=633776.70	NONE
#660 LEILA AVE	ACTIVE	150 UNKNOW	N=5534671.93 E=633771.07	UNKNOW	NONE
#662 LEILA AVE	ACTIVE	150 UNKNOW	N=5534673.29 E=633768.17	UNKNOW	NONE

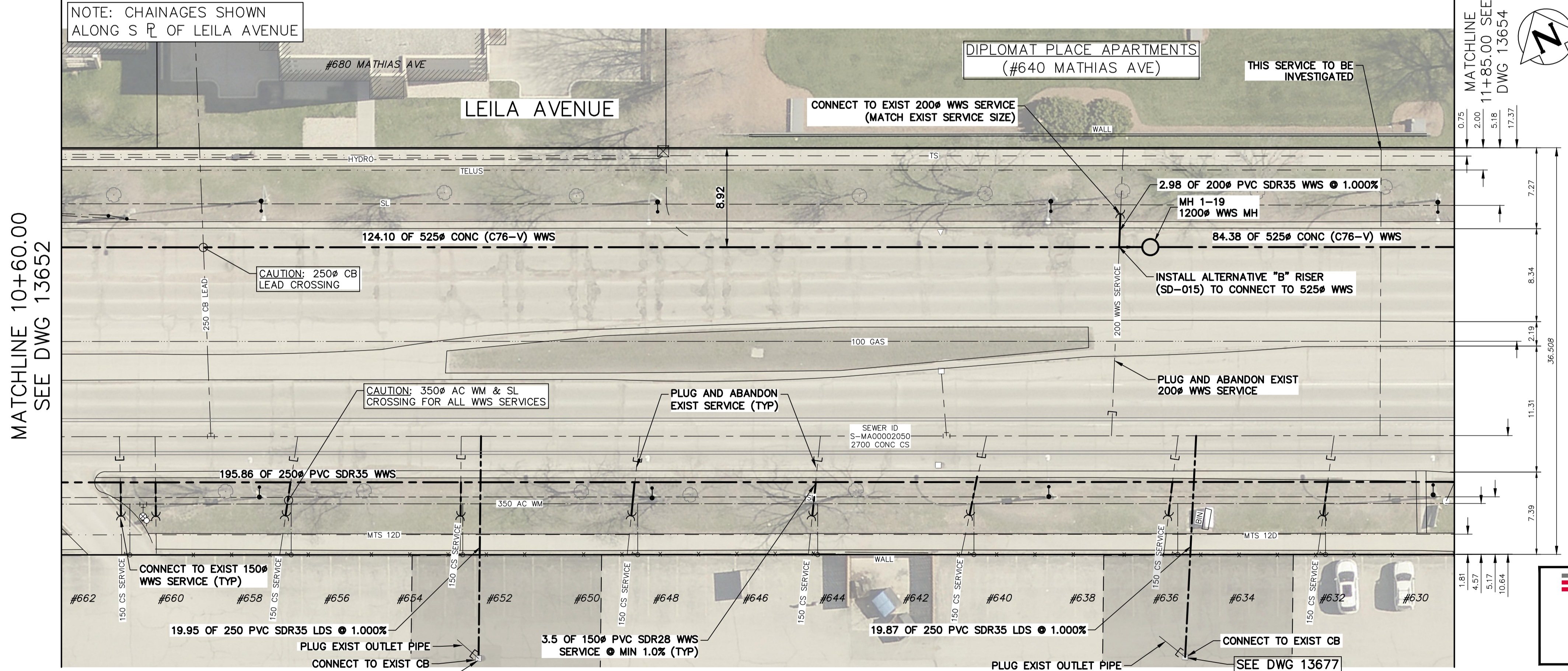

SEWER JUNCTION INFORMATION FROM SEWER VIDEO INSPECTION		
SEWER ID	S	MA00002050
DISTANCE FROM MH ID S-MH0001804	DISTANCE	DIAMETER
	33.3	150
	36.5	150
	41.5	250
	49.3	150
	64.0	150
	80.0	150
	96.2	150
	107.5	300
	111.1	150
	122.3	200
	128.3	150
	142.3	150
	146.4	250

MATCHLINE 10+60.00 SEE DWG 13652

MATCHLINE 11+85.00 SEE DWG 13654

**ENGINEERS GEOSCIENTISTS MANITOBA**  
Certificate of Authorization  
KGS Group  
No. 245

FOR INDEX PAGE SEE DWG 13643

**METRIC**  
WHOLE NUMBERS INDICATE MILLIMETRES  
DECIMALIZED NUMBERS INDICATE METRES

SCALE 1:250 (A1)

**WARNING**  
IF POWER EQUIPMENT OR EXPLOSIVES ARE TO BE USED FOR EXCAVATION ON THIS PROJECT THE CONTRACTOR MUST:  
1) NOTIFY THE GAS COMPANY OF THE PROPOSED LOCATION OF EXCAVATION.  
2) TAKE PRECAUTION TO AVOID DAMAGE TO GAS COMPANY INSTALLATIONS.  
SEE PROVINCIAL REGULATION 21072 FOR DETAILS

**LOCATION APPROVED UNDERGROUND STRUCTURES**  
SUPV. U/G STRUCTURES COMMITTEE DATE  
NOTE:  
LOCATION OF UNDERGROUND STRUCTURES AS SHOWN ARE BASED ON THE BEST INFORMATION AVAILABLE BUT NO GUARANTEE IS GIVEN THAT ALL EXISTING UTILITIES ARE SHOWN OR THAT THE GIVEN LOCATIONS ARE EXACT. CONFIRMATION OF EXISTENCE AND EXACT LOCATION OF ALL SERVICES MUST BE OBTAINED FROM THE INDIVIDUAL UTILITIES BEFORE PROCEEDING WITH CONSTRUCTION.

VERTICAL DATUM: CGVD28 (HT2.0 Geoid)  
HORIZONTAL DATUM: NAD83 (June 1990), Zone 14

NO.	ISSUED FOR CONSTRUCTION	DATE (YYYY/MM/DD)	MID	BY
0	ISSUED FOR CONSTRUCTION	2026/03/10		

**KGS GROUP**

DESIGNED BY	MID	CHECKED BY	TLE
DRAWN BY	GEL	APPROVED BY	RBO
SCALE:		RELEASED FOR CONSTRUCTION	
HORIZONTAL	1:250	DUANE BAKER	
VERTICAL	1:50	DATE	2026/03/12

PLOT DATE:

ENGINEER'S SEAL  
ORIGINAL DRAWING SEALED BY:  
M.A. IANKOVA-DEDOVA  
2026/03/11  
CONSULTANT DRAWING NUMBER  
C1-12

**THE CITY OF WINNIPEG**  
WATER AND WASTE DEPARTMENT  
ENGINEERING SERVICES DIVISION

**ARMSTRONG SEWER RELIEF WORKS**  
CONTRACT 1  
LEILA AVENUE  
20.5 E OF SINCLAIR STREET TO  
5.7 W OF MONSEY STREET

SHEET 12 OF 46  
CITY DRAWING NUMBER  
13653